

SADOWSKI CAUSEWAY

CONCEPT 1(GROUND FLOOR)	
NARRATIVE 02/25/25	
<p>In concept 1, the lobby is included in the addition, on the west side of the building, providing direct covered access from the parking lot. Its central position ensures smooth circulation to adjacent department suites and a clear path to the Police Department. The City Administration Department is placed on the second floor, offering private access for added security and separation from public areas. The roof of the existing 2nd floor building department will be raised so the floor can be level with the city administration. This design prioritizes convenience, security, and efficient movement throughout the building.</p>	
PROS	CONS



KEY COLONY  
BEACH CITY HALL  
CONCEPT 1



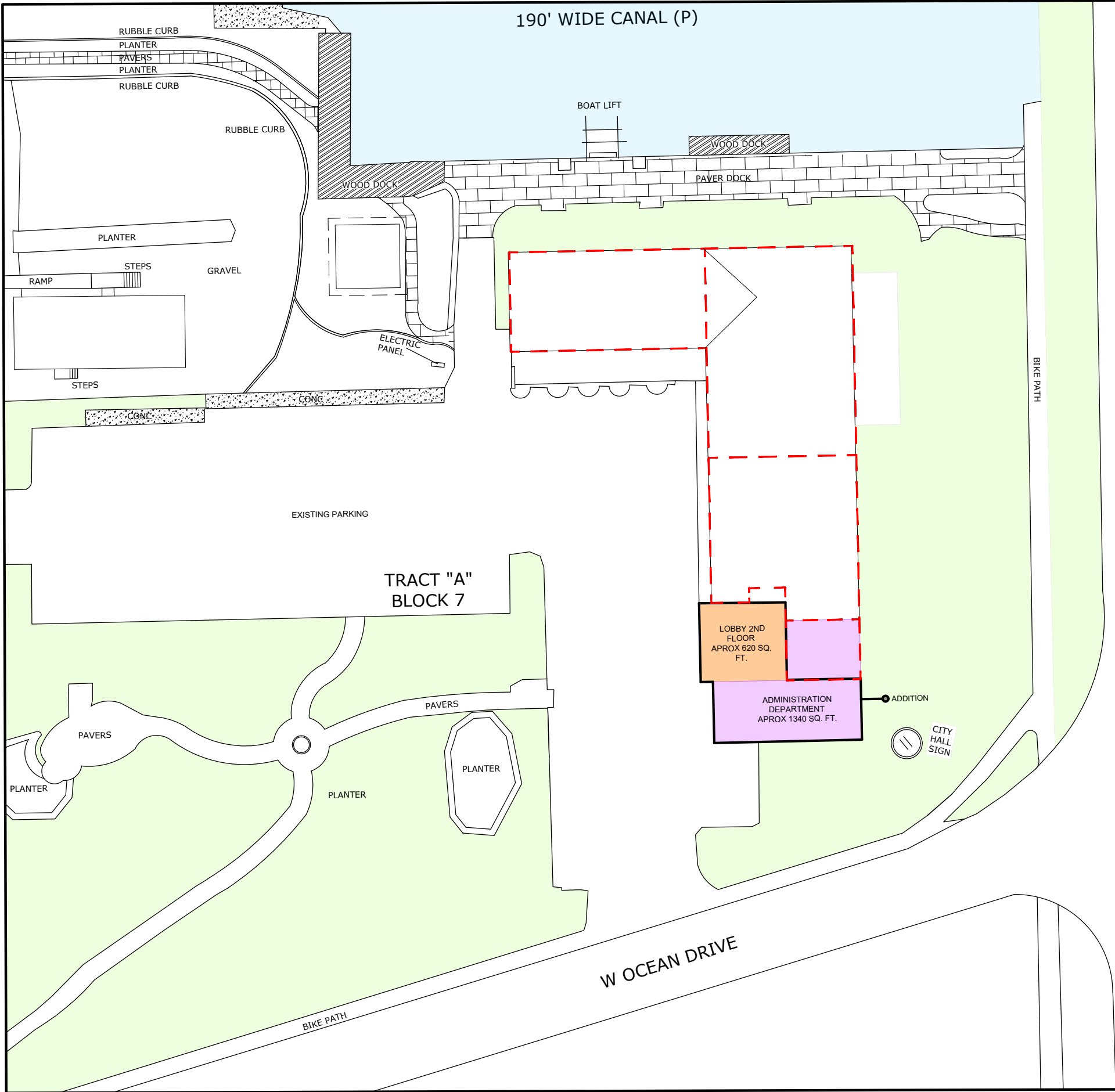

SADOWSKI CAUSEWAY

CONCEPT 1(SECOND FLOOR)

NARRATIVE 02/25/25

In concept 1, the lobby is included in the addition, on the west side of the building, providing direct covered access from the parking lot. Its central position ensures smooth circulation to adjacent department suites and a clear path to the Police Department. The City Administration Department is placed on the second floor, offering private access for added security and separation from public areas. The roof of the existing 2nd floor building department will be raised so the floor can be level with the city administration. This design prioritizes convenience, security, and efficient movement throughout the building.

PROS

CONS



KEY COLONY  
BEACH CITY HALL  
CONCEPT 1

2/25/2025















# KEY COLONY BEACH CITY HALL

CONCEPT 1

2/25/2025



LEGEND	
	POST OFFICE
	MARBLE HALL
	POLICE DEPARTMENT
	MEN & WOMEN RESTROOMS
	MECHANICAL, ELECTRICAL, IT & JANITOR ROOM
	MAIN LOBBY
	CIRCULATION
	ADMINISTRATION DEPARTMENT
	BUILDING DEPARTMENT
	EXERCISE ROOM

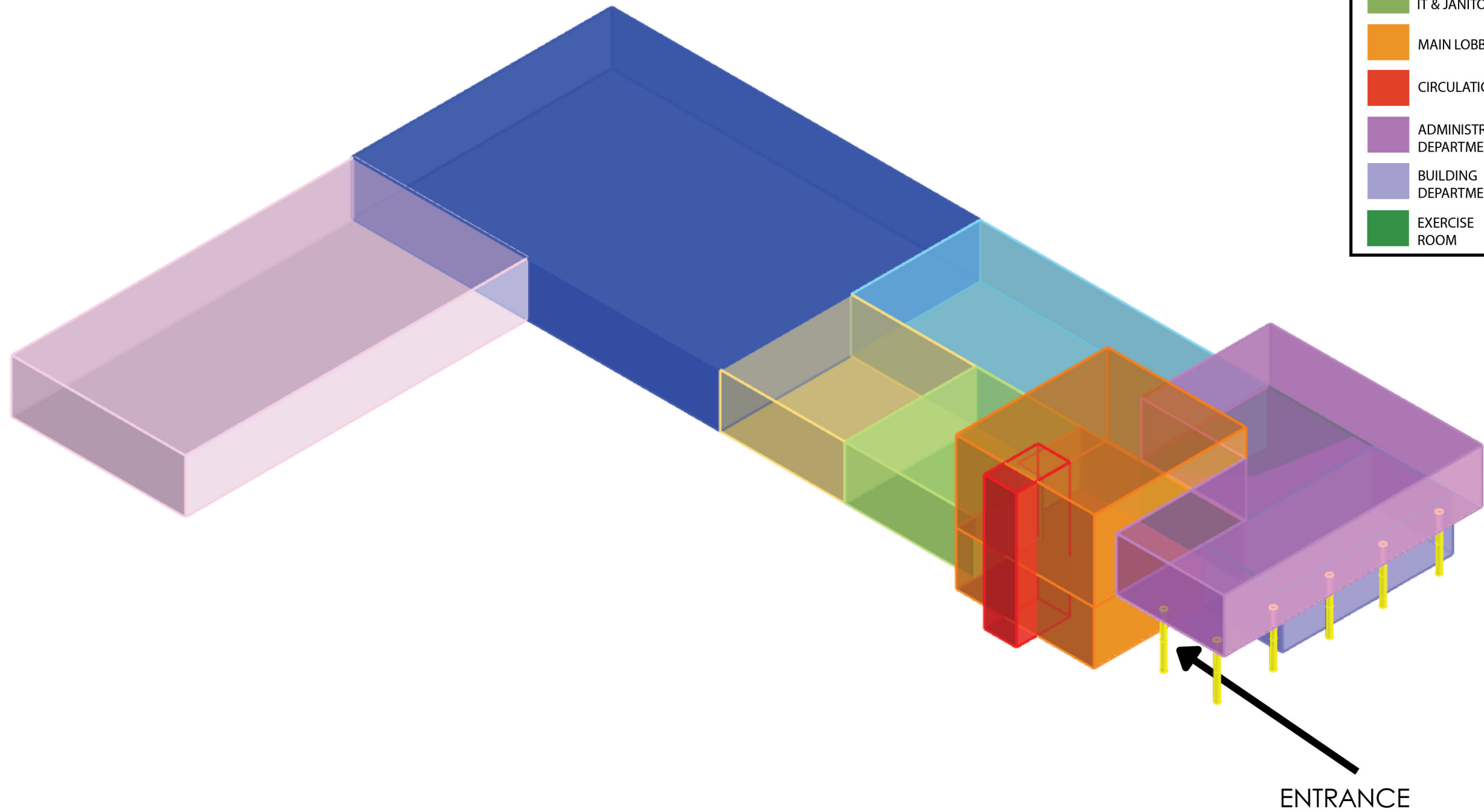

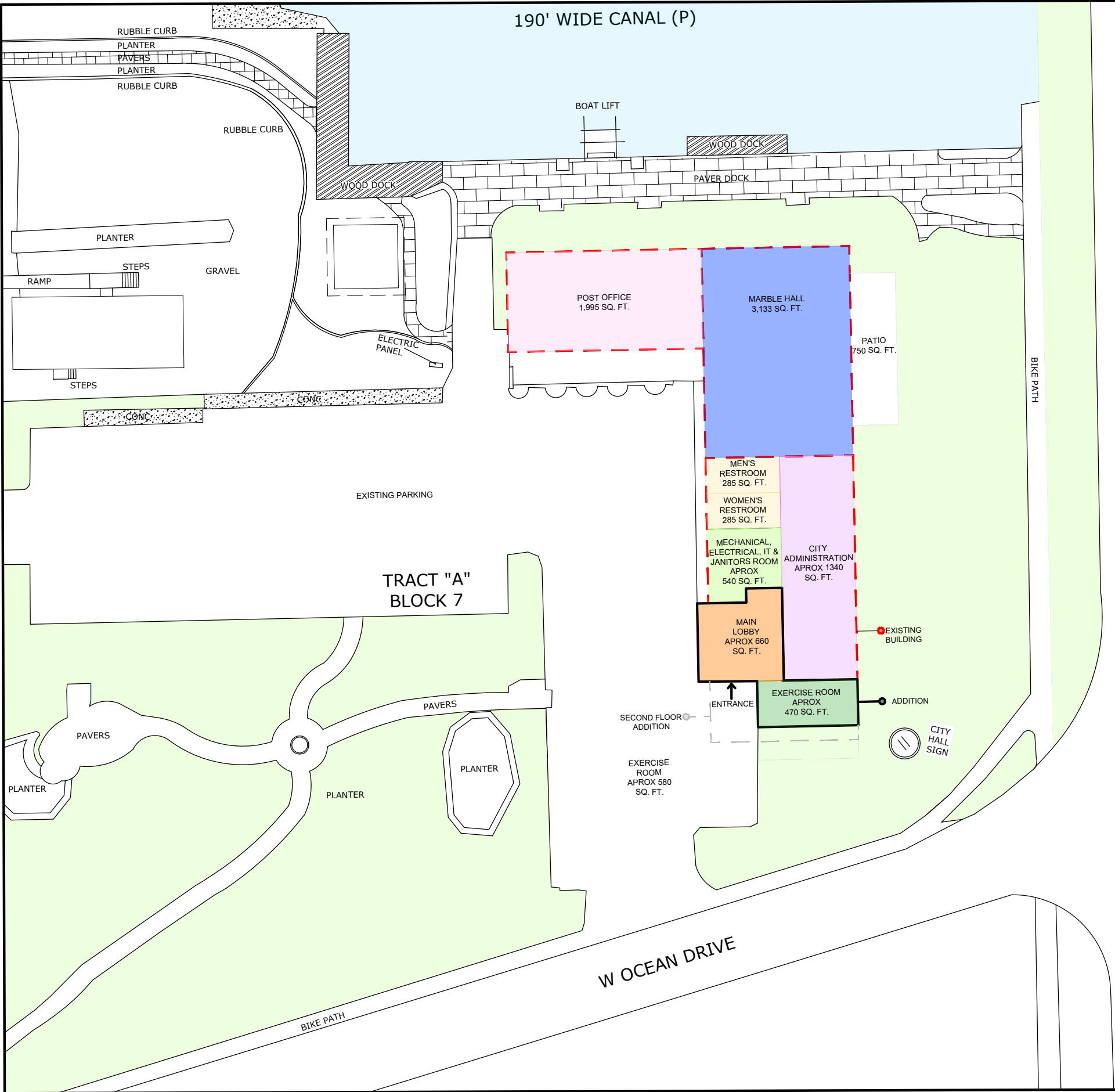

SADOWSKI CAUSEWAY

CONCEPT 2 (GROUND FLOOR)

NARRATIVE 02/25/25

In concept 2, the lobby is included in the addition on the west side of the building, providing direct covered access from the parking lot. Its central position ensures smooth circulation to adjacent department suites, with clear access to the Administration Department on the first floor. The Police and Building Departments are placed on the second floor. The roof of the existing 2nd floor Building Department will be raised so the floor can be level with the new police department floor. This layout prioritizes convenience, security, and efficient movement throughout the building.

PROS

CONS



KEY COLONY  
BEACH CITY HALL  
CONCEPT 2

2/25/2025





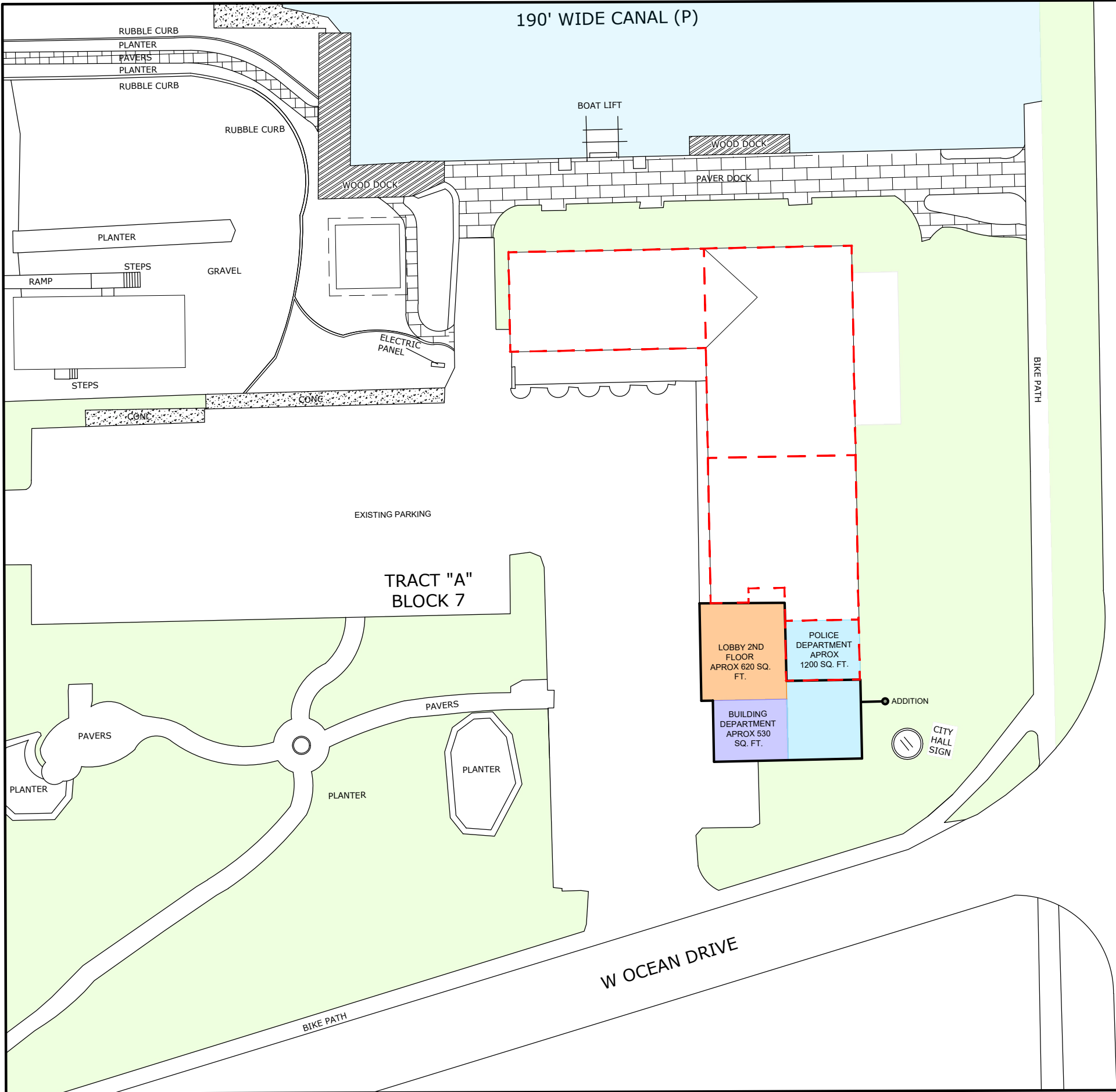

SADOWSKI CAUSEWAY

CONCEPT 2 (SECOND FLOOR)

NARRATIVE 02/25/25

In concept 2, the lobby is included in the addition on the west side of the building, providing direct covered access from the parking lot. Its central position ensures smooth circulation to adjacent department suites, with clear access to the Administration Department on the first floor. The Police and Building Departments are placed on the second floor. The roof of the existing 2nd floor Building Department will be raised so the floor can be level with the new police department floor. This layout prioritizes convenience, security, and efficient movement throughout the building.

PROS

CONS



KEY COLONY  
BEACH CITY HALL  
CONCEPT 2

2/25/2025





# KEY COLONY BEACH CITY HALL

CONCEPT 2

2/25/2025



## LEGEND

- POST OFFICE
- MARBLE HALL
- POLICE DEPARTMENT
- MEN & WOMEN RESTROOMS
- MECHANICAL, ELECTRICAL, IT & JANITOR ROOM
- MAIN LOBBY
- CIRCULATION
- ADMINISTRATION DEPARTMENT
- BUILDING DEPARTMENT
- EXERCISE ROOM

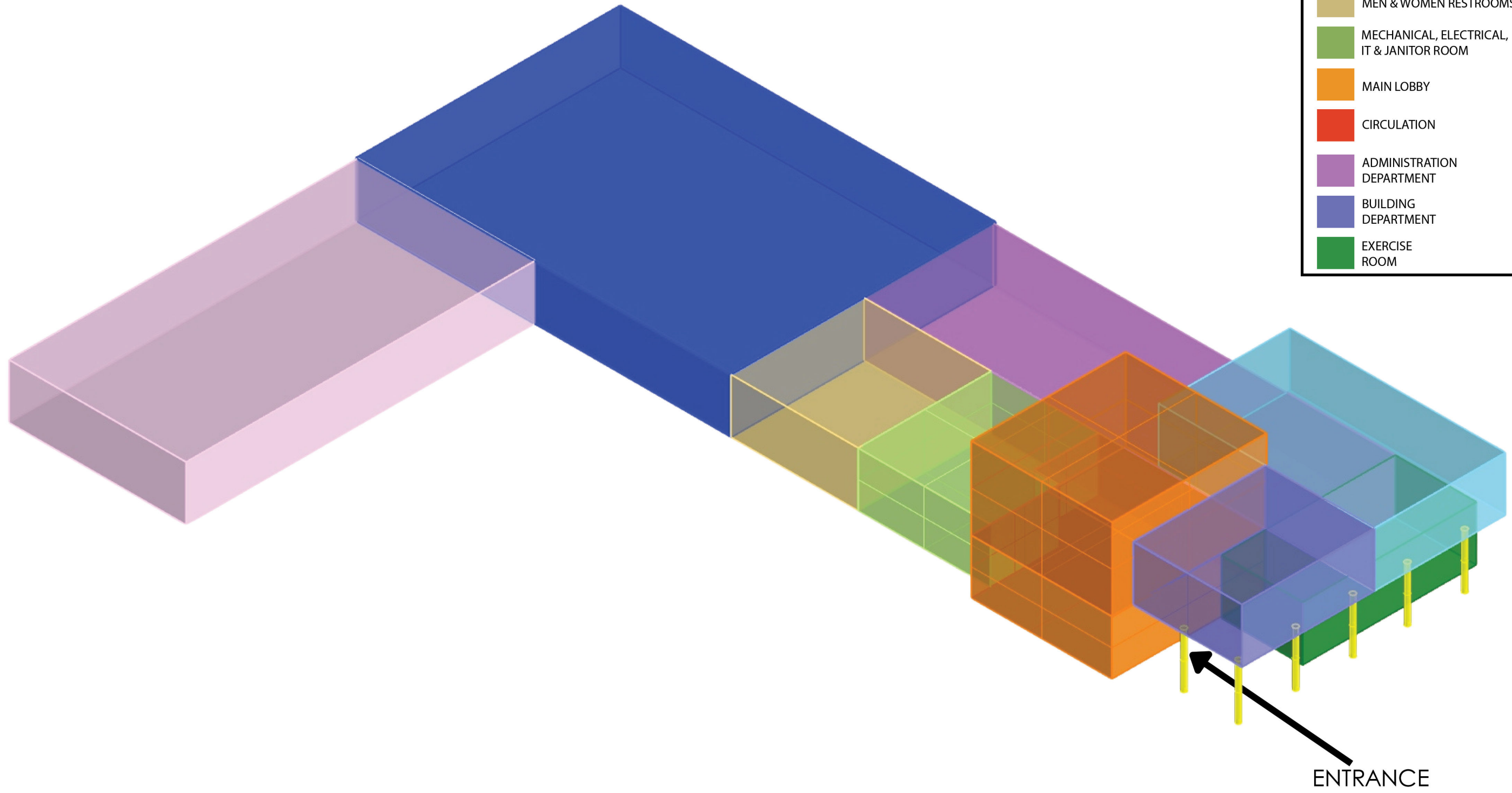

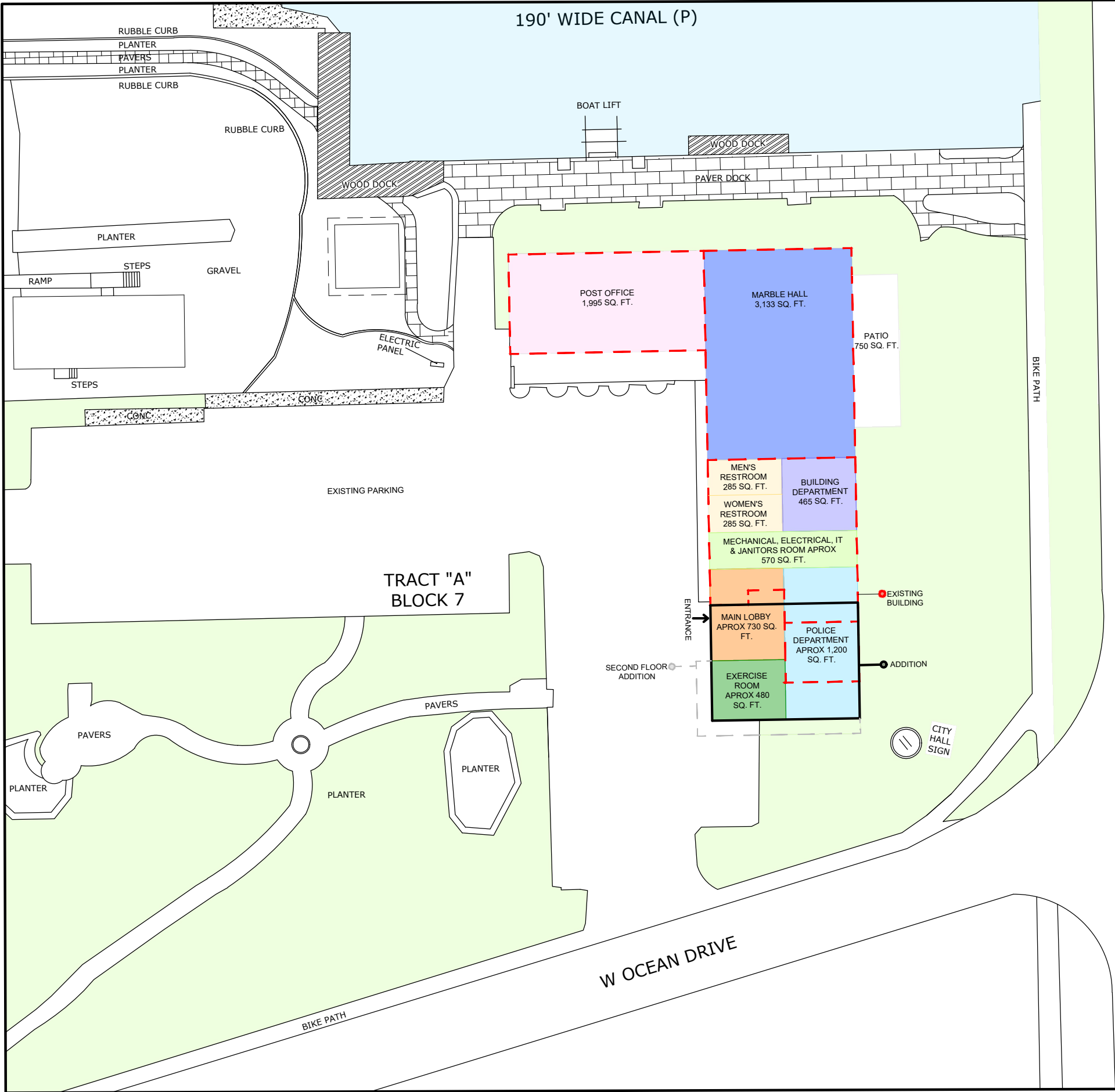

SADOWSKI CAUSEWAY

CONCEPT 3 (GROUND FLOOR)	
NARRATIVE 02/25/25	
<p>In concept 3, the lobby is more centralized, with a key design change being the removal of 2 portions of the building's existing wall. The exercise room and police department stretch along the south facade, maximizing natural light and views. The Administration Department is located on the second floor, providing a more private setting for added security and separation from public spaces. This layout emphasizes accessibility, privacy, and an efficient flow between departments.</p>	
PROS	CONS



KEY COLONY  
BEACH CITY HALL  
CONCEPT 3

2/25/2025



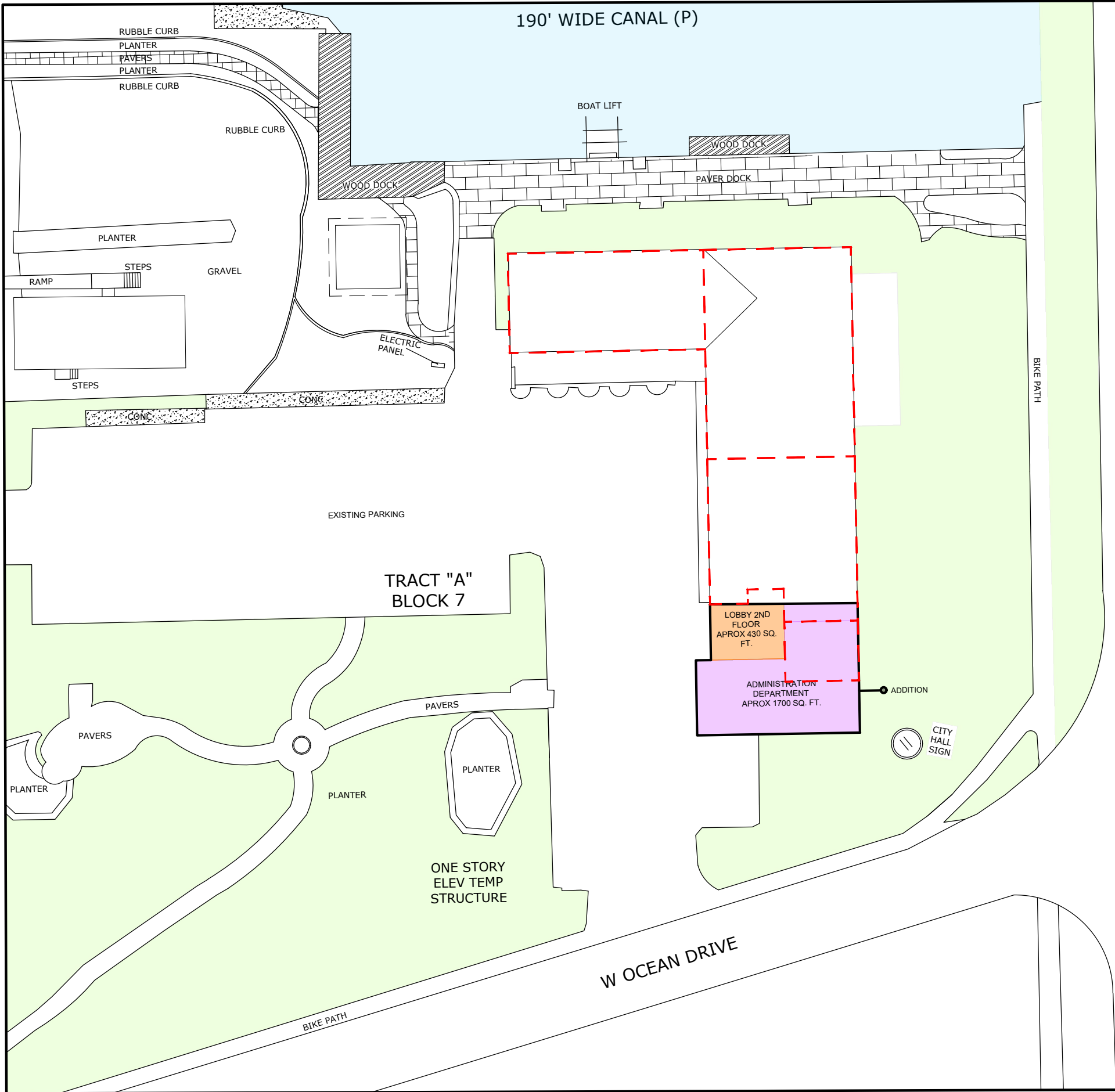

SADOWSKI CAUSEWAY

CONCEPT 3 (SECOND FLOOR)	
NARRATIVE 02/25/25	
<p>In concept 3, the lobby is more centralized, with a key design change being the removal of 2 portions of the building's existing wall. The exercise room and police department stretch along the south facade, maximizing natural light and views. The Administration Department is located on the second floor, providing a more private setting for added security and separation from public spaces. This layout emphasizes accessibility, privacy, and an efficient flow between departments.</p>	
PROS	CONS



KEY COLONY  
BEACH CITY HALL  
CONCEPT 3







KEY COLONY  
BEACH CITY HALL  
CONCEPT 3

2/25/2025



- LEGEND
- POST OFFICE
  - MARBLE HALL
  - POLICE DEPARTMENT
  - MEN & WOMEN RESTROOMS
  - MECHANICAL, ELECTRICAL, IT & JANITOR ROOM
  - MAIN LOBBY
  - CIRCULATION
  - ADMINISTRATION DEPARTMENT
  - BUILDING DEPARTMENT
  - EXERCISE ROOM

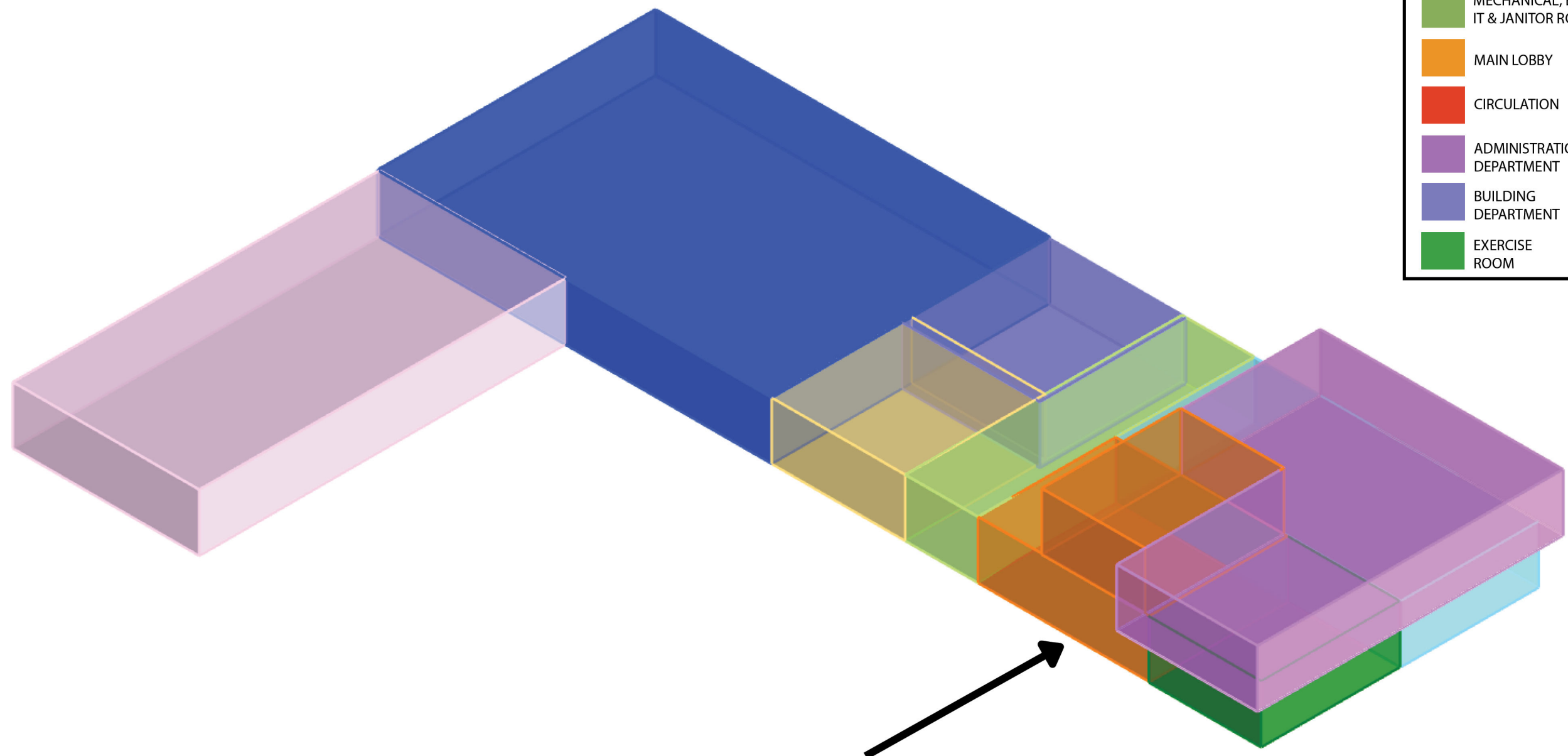

ENTRANCE